

HERO

session™

LET'S GET STARTED

Complete user manual available at gopro.com/help.

SET UP

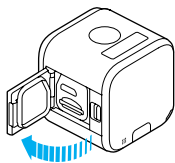

Open the side door.

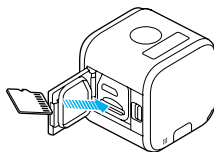

Insert a microSD™ card
(sold separately).

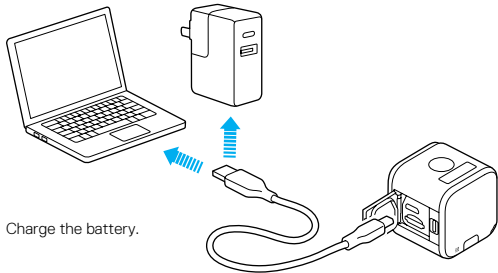

Charge the battery.

NOTICE

The camera is not waterproof when the door is open.

CAPTURE VIDEO + PHOTOS



Video



Time Lapse

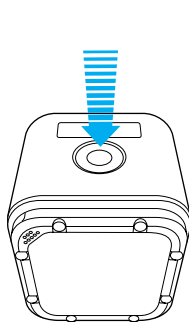

Short press records in Video mode.

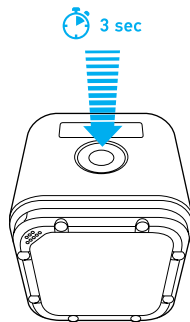

Long press records in
Time Lapse mode.

CHANGE MODES + SETTINGS

Press to turn on, then press to move through the menus.

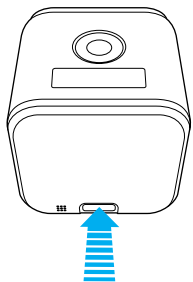

Select an option.

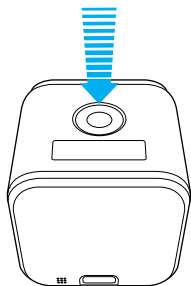

CAMERA MOUNTING

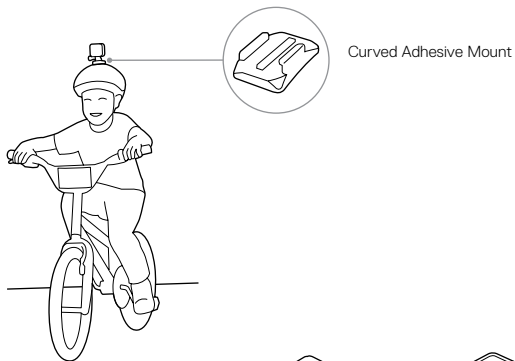

Curved Adhesive Mount

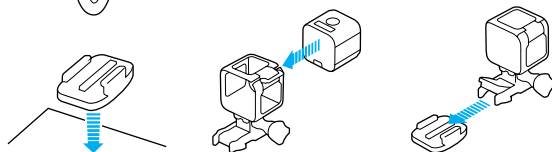

Apply an adhesive mount to a clean surface at room temperature.

Insert the camera into the mounting frame.

Click the mounting buckle into the adhesive mount.

TIP

After use in sand, dirt or salt water, rinse the camera in fresh water.

APPS

Capture and create stunning videos. Our mobile and desktop apps make it easy.



CAPTURE

Live preview, playback + full camera control.



QUIK™

Awesome edits made easy.



QUIK | DESKTOP

Import and enjoy your footage, and create awesome videos with just a few clicks.

▶ Download at gopro.com/apps

UPDATE YOUR GOPRO

Connect to the Capture app or Quik desktop app to check for updates and get the latest camera features.

MORE FROM GOPRO

PLUS

ACCESS + SHARE FROM ANYWHERE

A GoPro Plus subscription makes it easy to access, edit and share your GoPro photos and videos—anytime, anywhere. You'll also enjoy 20% off mounts and accessories,* premium support and more.

▶ Start your free trial at gopro.com/plus

**Exclusions apply.*



GOPRO AWARDS

Submit your best photos and videos to GoPro. Our favorites receive cash awards.

▶ Submit at gopro.com/awards



See the list of country certifications in Important Product + Safety Instructions.